

# Layout of Session

## V Floor

(It is between lobby and 2<sup>nd</sup> floor)

(Please use center stairs in lobby to access to V floor)

Room: FV 107, 108, 109

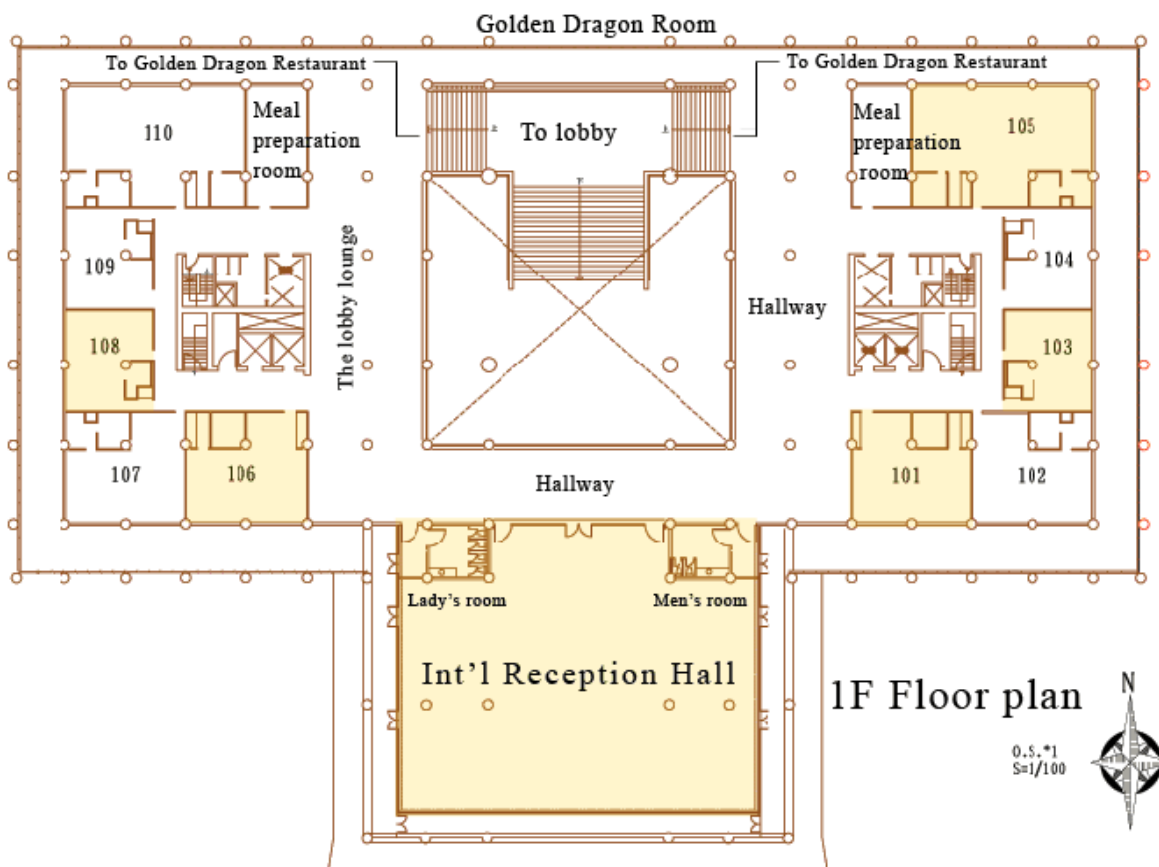

# Grand Hotel Transportation Information

Hotel Address:

No.1, Sec. 4, Zhongshan N. Rd., Zhongshan Dist., Taipei City 10461, Taiwan (R.O.C.)

Hotel Tel: +886-2-2886-8888

Hotel Fax: +886-2-2885-2885

Website: <http://www.grand-hotel.org/main/Default.aspx?lang=en-US>

## Airport – Grand Hotel

### 1. CitiAir Bus No. 2061-West Express (Shuttle Service)

Schedule for Airport Shuttle Service (Taiwan Taoyuan International Airport)

From Hotel			From Terminal 1	From Terminal 2
05:10	10:20	15:20	06:00~01:00 The service is available every 20 to 30 minutes.	05:55~24:55 The service is available every 20 to 30 minutes.
06:10	11:20	16:20		
07:20	12:20	17:20		
08:20	13:20	18:20		
09:20	14:20	19:20		
<p>✧ Cost: full fare is NT\$90 per person each way; discounted fare at NT\$45 (available for children between 110cm and 145cm of height or those with a government-issued handbook for the disabled) per person each way.</p> <p>✧ Travel time: It takes 60 to 80 minutes to travel from the Grand Hotel to the Taiwan Taoyuan International Airport (44 km).</p>				

### 2. Taxi

About NT\$1000 (Taxi fare is based on the meter plus a 15% surcharge, and highway tolls is not included.)

# Public Transportation in Taipei City

## Free Shuttle Service (MRT)

The Grand Hotel offers a free shuttle service between the hotel and the MRT system (Red Line). The shuttle bus stop is located on the opposite side of Exit 1 of MRT Yuanshan Station on Yumen Street, alongside other public bus stops.

## Schedule for Free Shuttle Service (MRT)

From Hotel			From MRT		
06:30	12:20	17:40	06:40	12:30	17:50
07:00	12:40	18:00	07:10	12:50	18:10
07:30	13:00	18:20	07:40	13:10	18:30
08:00	13:30	18:40	08:10	13:40	18:50
08:20	14:00	19:00	08:30	14:10	19:10
08:40	14:30	19:20	08:50	14:40	19:30
09:00	15:00	19:40	09:10	15:10	19:50
09:30	15:20	20:00	09:40	15:30	20:10
10:00	15:40	20:20	10:10	15:50	20:30
10:30	16:00	20:40	10:40	16:10	20:50
11:00	16:20	21:00	11:10	16:30	21:10
11:20	16:40	21:20	11:30	16:50	21:30
11:40	17:00	21:40	11:50	17:10	21:50
12:00	17:20	22:00	12:10	17:30	22:10

Schedule for Free Shuttle Service (MRT) (valid from Oct. 1, 2008)